

CELLA DI CARICO OFF-CENTER

Carico nominale 3-5 tonnellate



SKX-5T

SPECIFICHE TECNICHE

Sensitivity	mV/V	2±0.01
Total Error	%FS	±0.03
Repeatability	%FS	±0.01
Creep	%FS/30min	±0.025
Zero Balance	%FS	±1
Zero Temperature Drift	%FS/10°C	±0.015
Rated Output Temperature Drift	%FS/10°C	±0.015
Input Resistance	Ω	385±20
Output Resistance	Ω	350±5
Insulation Resistance	MΩ	≥ 5.000
Supply Voltage	Vac/dc	10 ÷ 15
Compensated Temperature Range	°C	-10 ÷ +40
Operating Temperature Range	°C	-30 ÷ +60
Safe Overload	%FS	150
Ultimate Overload	%FS	200
Material		Stainless steel
Sealing		IP68-Resin Potted
Cable (Diameter/Length)		Ø 5 mm / 5m
Cable Color Code		Input: Brown(+), Green (-) Sense: Grey (+), Pink (-) Signal: Yellow (+), White (-)
Rated Load	Kg	3.000-5.000

DIMENSIONI

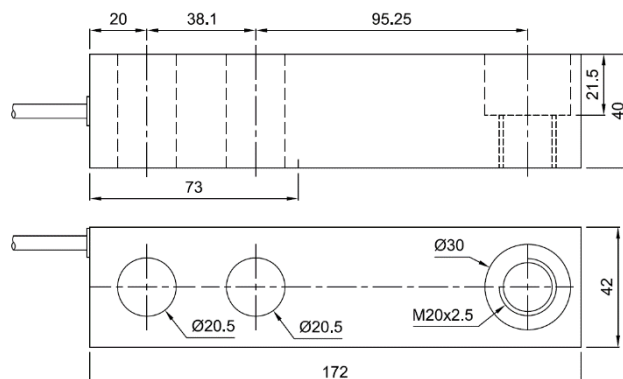

CELLA DI CARICO OFF-CENTER

Carico nominale 3-5 tonnellate



DISPOSIZIONE A 3 O 4 CELLE DI CARICO

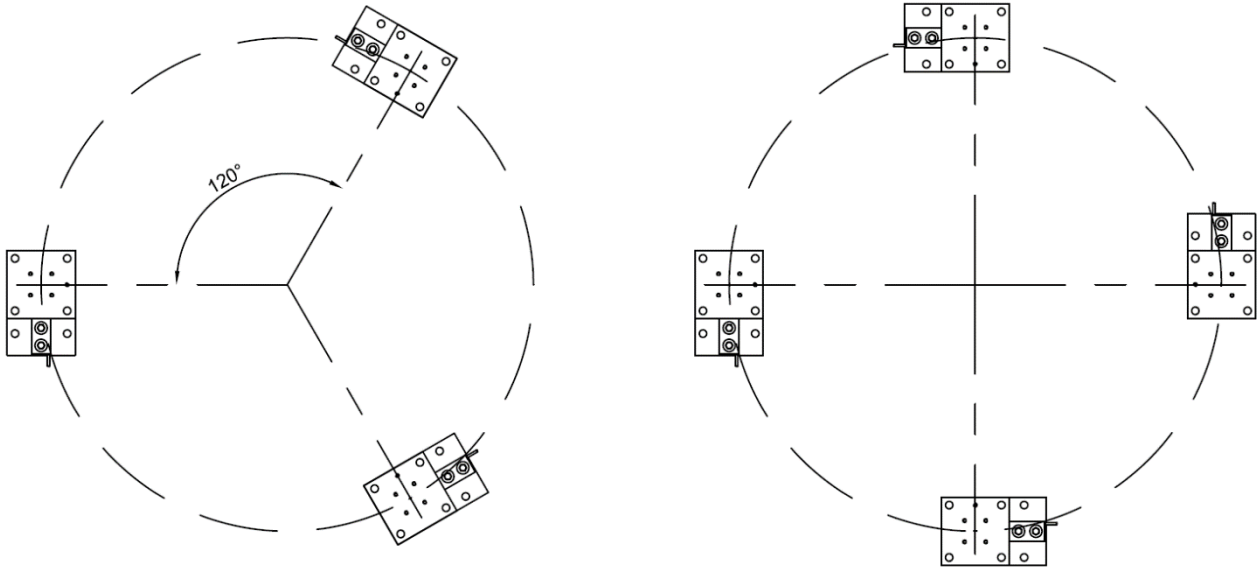

SISTEMA DI MONTAGGIO MOD. MK-SSB-PZ-5T

